

# HUNTERS®

HERE TO GET *you* THERE



## 52 Kent Road

Gravesend, DA11 0SY

Guide Price £500,000-£525,000



GUIDE PRICE: £500,000-£525,000

Hunters Gravesend are delighted to offer for sale this double bay fronted Period property situated in a sought-after road and is within half a mile of Gravesend Town Centre and Mainline Railway Station offering the Fast Service into London St. Pancras in under Twenty-Five Minutes.

The ground floor accommodation comprises of door to entrance hall, stairs to first floor, doors to, lounge, dining room, breakfast room, kitchen, and Shower Room.

On the first floor there are three double bedrooms and family bathroom. Whilst the second floor boasts a double bedroom with storage eaves.

Externally there is a walled frontage, and the rear garden is laid to lawn and decked area.



- Lounge 11'5" x 14'6" (3.47 x 4.41)
- Breakfast Room 8'10" x 13'11" (2.7 x 4.24)
- Dining Room 9'8" x 12'5" (2.95 x 3.78)
- Kitchen 8'7" x 9'2" (2.61 x 2.8)
- Shower Room
- Bedroom 14'7" x 15'4" (4.44 x 4.67)
- Bedroom 9'1" x 13'0" (2.76 x 3.96)
- Bedroom 9'9" x 12'5" (2.98 x 3.79)
- Bathroom
- Bedroom 14'2" x 18'2" (4.31 x 5.53)

Area Map



Floor Plans

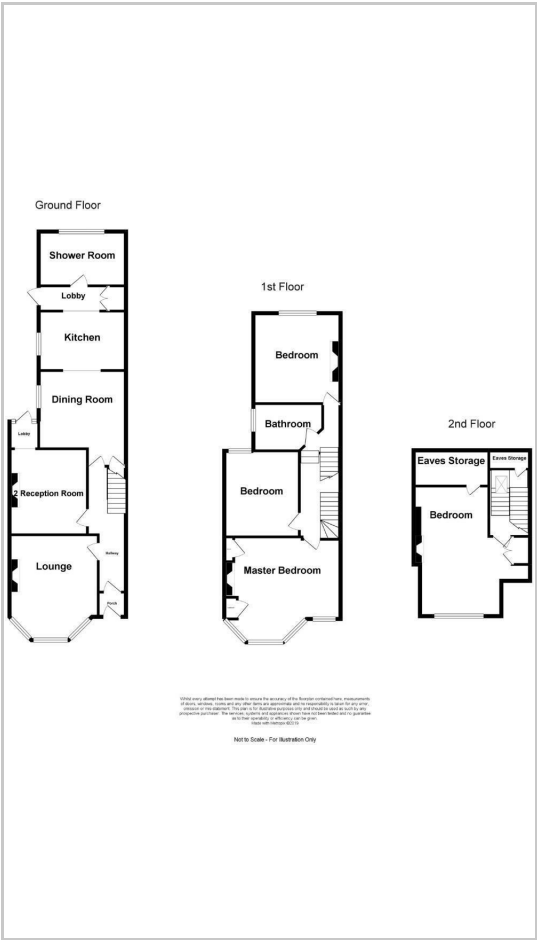

Energy Efficiency Graph

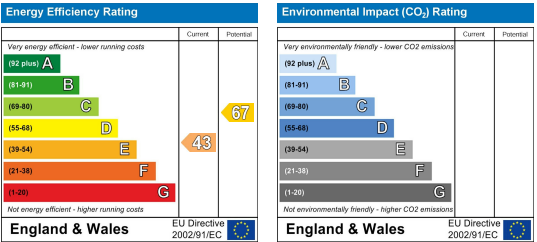

These particulars are intended to give a fair and reliable description of the property but no responsibility for any inaccuracy or error can be accepted and do not constitute an offer or contract. We have not tested any services or appliances (including central heating if fitted) referred to in these particulars and the purchasers are advised to satisfy themselves as to the working order and condition. If a property is unoccupied at any time there may be reconnection charges for any switched off/disconnected or drained services or appliances - All measurements are approximate. **THINKING OF SELLING?** If you are thinking of selling your home or just curious to discover the value of your property, Hunters would be pleased to provide free, no obligation sales and marketing advice. Even if your home is outside the area covered by our local offices we can arrange a Market Appraisal through our national network of Hunters estate agents.